

# SW-301

Wallmounting Stand



## Product Parameters

Model	Specifications	Tablet Compatibility
SW-301A-A1	293W x 210D x 97H mm 11.5W x 8.3D x 3.8H inch	Applicable for iPad Air 1,2 ; iPad 5,6 and iPad PRO 9.7"
	<b>Material</b>	<b>Net Weight</b>
	SPCC	2.5kg/5.5LBS
	<b>Color Options</b>	
	Black, white and Customized	



## Product Features



**Metal Construction**

**Quick access to tablet with key lock**



lock



**360° Rotation for alternative viewing angles**

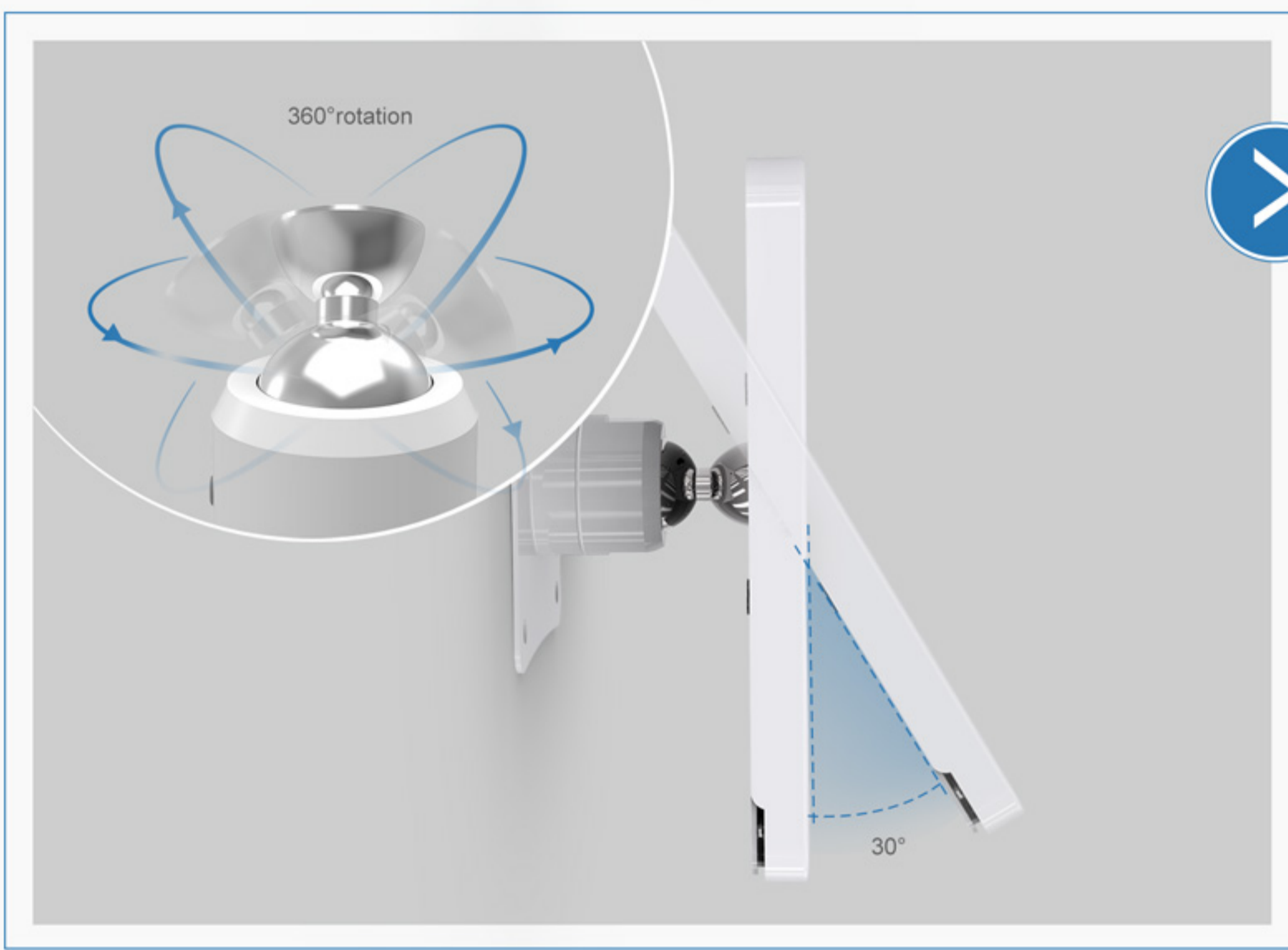

**Adjustment of tightness**



loose

tight



**Xiamen Mihler Tech Co., Ltd.**

Add: No.77, Huli Industrial Zone, Xike, Tong'an District, Xiamen 361100, Fujian China  
E-mail: sales@mihler.com Tel:+86-592-7116610  
Fax: +86-592-5768735 Website: www.mihler.com